

Commonly used on apartment and condominium doors, ASSA rim cylinders are used on vertical deadbolt locks and are also designed for commercial exit and panic devices. Available with either horizontal/vertical break-off or lazy-motion type break-off tailpieces, ASSA rim cylinders can be ordered with the standard or the Sargent rim exit device mounting patterns. The standard rim cylinder can be easily converted to a mortise cylinder by simply replacing the rim tailpiece assembly with the appropriate cam.



### Benefits:

- Drill resistant cylinder housing and plug
- Case-hardened steel inserts and stainless steel pins
- Two independent locking mechanisms to ensure security and optimum pick resistance
- Inactive “false” gates in side pins designed to increase pick resistance
- Counter mill in each chamber position to further enhance pick resistance
- Extremely close tolerances
- Can be easily rekeyed in the field
- Standard and Sargent hole pattern available
- Standard rim cylinder is easily converted to mortise cylinder

### Warranty:

- ASSA warrants its cylinders against defective workmanship or wear resulting from defects for one year

### Certification:

- All ASSA High Security Rim cylinders are U.L. 437 Listed

### Technical Information:

- Available with limited rotation and/or unidirectional features
- Cylinder housing and plug are made of high quality brass
- Stainless steel top pins
- Bottom pins and master pins are nickel silver

### Finishes:

BHMA Symbol	U.S. Symbol	Description
625	US 26	Bright Chrome
626	US 26D	Satin Chrome
605	US 3	Bright Brass
606	US 4	Satin Brass
612	US 10	Satin Bronze
624	US 10B	Dark Oxidized Bronze

Note: Plug finishes available in 626 and 606 only.

General Info.

Electronic Access Control

Keys & Keying

Mortise Cyls.

**Rim Cyls.**

Mogul Cyls.

IC Core Cyls.

KIK/KIL Cyls.

Deadbolts

Auxiliary Locks

Padlocks

Profile Cyls.

Pin Kits Tools & Accessories

Care & Maint.

Technical Specs.

General Info.

Electronic Access Control

Keys & Keying

Mortise Cyls.

Rim Cyls.

Mogul Cyls.

IC Core Cyls.

KIK/KIL Cyls.

Deadbolts

Auxiliary Locks

Padlocks

Profile Cyls.

Pin Kits Tools & Accessories

Care & Maint.

Technical Specs.

### Rim Cylinders Cut-Away View

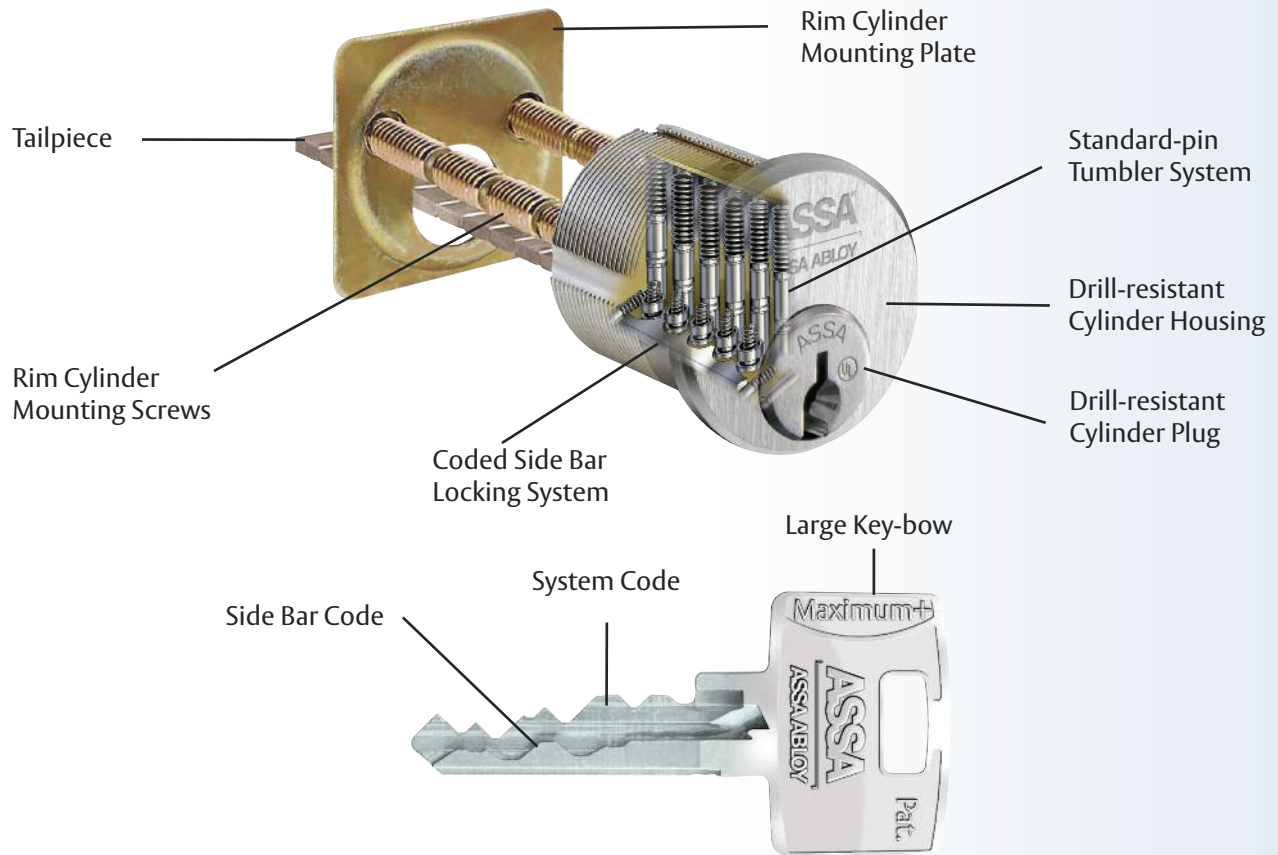

### Rim Cylinders Exploded View

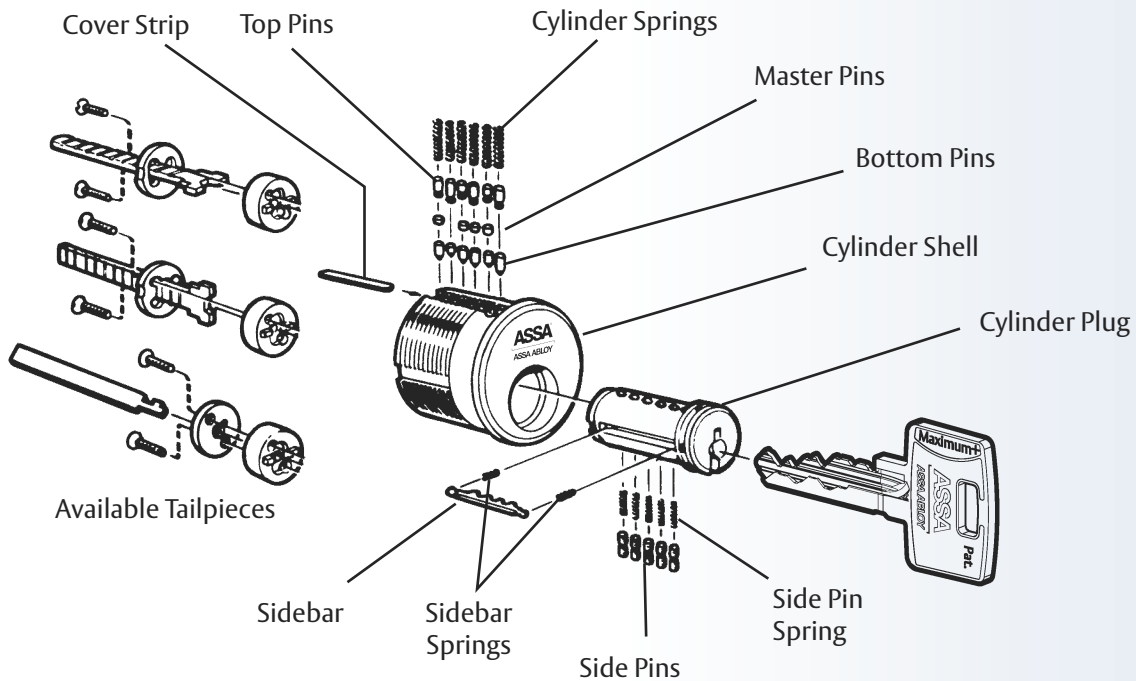

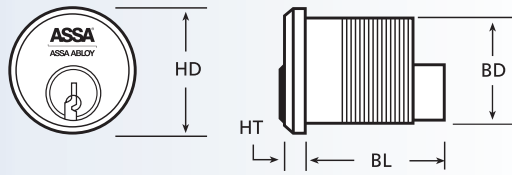

Mortise Cylinder Key:  
HD – Head Diameter

HT – Head Thickness

BL – Body Length (Includes Retainer)

BD – Body Diameter

### Available Tailpieces

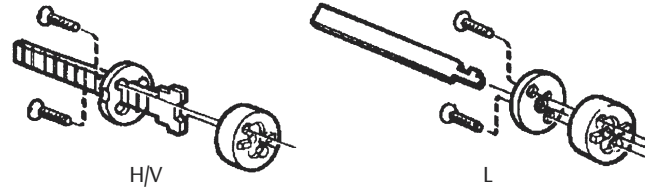

H/V

L

Model#	Tailpiece (Specify)	Notes	Description	HD	HT	BL	BD
<b>Maximum+ Rim Cylinders</b>							
9851	H, V, or L	†	1-1/8" Rim Cylinder	1.366"	0.138"	1.290"	1.157"
7951	H, V, or L	†	Corbin Jumbo Rim Cylinder	1.643"	0.170"	1.270"	
S9851	H, V, or L	†	Special SARGENT Cylinder (Drilled for SGT. Devices)	1.366"	0.138"	1.290"	
<b>Maximum+ Restricted Rim Cylinders</b>							
R2851	H, V, or L		1-1/8" Rim Cylinder	1.366"	0.138"	1.290"	1.157"
RS2851	H, V, or L		Special SARGENT Cylinder (Drilled for SGT. Devices)				
<b>Twin Maximum Rim Cylinders</b>							
8851	H, V, or L	†	1-1/8" Rim Cylinder	1.366"	0.138"	1.290"	1.157"
7851	H, V, or L	†	Corbin Jumbo Rim Cylinder	1.643"	0.170"	1.270"	
S8851	H, V, or L	†	Special SARGENT Cylinder (Drilled for SGT. Devices)	1.366"	0.138"	1.290"	
<b>Twin Exclusive Rim Cylinders</b>							
E6551	H, V, or L	†	1-1/8" Rim Cylinder	1.366"	0.138"	1.290"	1.157"
E7551	H, V, or L	†	Corbin Jumbo Rim Cylinder	1.643"	0.170"	1.270"	
ES6551	H, V, or L	†	Special SARGENT Cylinder (Drilled for SGT. Devices)	1.366"	0.138"	1.290"	
<b>Twin 6000 Classic Rim Cylinders</b>							
6551	H, V, or L	†	1-1/8" Rim Cylinder	1.366"	0.138"	1.290"	1.157"
7551	H, V, or L	†	Corbin Jumbo Rim Cylinder	1.643"	0.170"	1.270"	
S6551	H, V, or L	†	Special SARGENT Cylinder (Drilled for SGT. Devices)	1.366"	0.138"	1.290"	
<b>Twin V-10 Rim Cylinders</b>							
V6551	H, V, or L	†	1-1/8" Rim Cylinder	1.366"	0.138"	1.290"	1.157"
V7551	H, V, or L	†	Corbin Jumbo Rim Cylinder	1.643"	0.170"	1.270"	
VS6551	H, V, or L	†	Special SARGENT Cylinder (Drilled for SGT. Devices)	1.366"	0.138"	1.290"	
<b>Twin Pro</b>							
6151	H, V, or L	†	1-1/8" Rim Cylinder	1.366"	0.138"	1.290"	1.157"
7151	H, V, or L	†	Corbin Jumbo Rim Cylinder	1.643"	0.170"	1.270"	
S6151	H, V, or L	†	Special SARGENT Cylinder (Drilled for SGT. Devices)	1.366"	0.138"	1.290"	
<b>Twin Low Rim Cylinders</b>							
L651	H, V, or L		1-1/8" Rim Cylinder	1.366"	0.138"	1.290"	1.157"
L751	H, V, or L		Corbin Jumbo Rim Cylinder	1.643"	0.170"	1.270"	
LS651	H, V, or L		Special SARGENT Cylinder (Drilled for SGT. Devices)	1.366"	0.138"	1.290"	
<b>600 Series Rim Cylinders</b>							
651	H, V, or L		1-1/8" Rim Cylinder	1.366"	0.138"	1.290"	1.157"
751	H, V, or L		Corbin Jumbo Rim Cylinder	1.643"	0.170"	1.270"	
S651	H, V, or L		Special SARGENT Cylinder (Drilled for SGT. Devices)	1.366"	0.138"	1.290"	

† Available in special function cylinders, see page 5.

– Twin Maximum available with CLIQ™ Technology. Example: 8851-H x CLIQ x 626 x Sidebar x Comp

General Info.

Electronic Access Control

Keys & Keying

Mortise Cyls.

Rim Cyls.

Mogul Cyls.

IC Core Cyls.

KIK/KIL Cyls.

Deadbolts

Auxiliary Locks

Padlocks

Profile Cyls.

Pin Kits Tools & Accessories

Care & Maint.

Technical Specs.

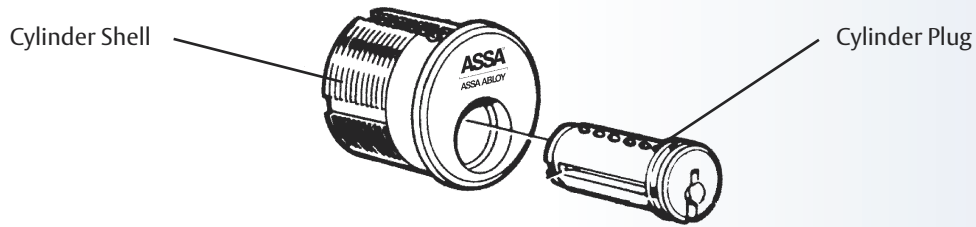

Model#	Notes	Description
<b>Maximum + / Twin Maximum / Twin Pro</b>		
354947	*	SARGENT Drilled Rim Shell
867429	*	1-1/8" Cylinder Shell
807987	*	Corbin Jumbo 1-1/8" Shell
356955	*	1-1/8" Cylinder Plug (Profile 0A7 or 0M7)
<b>Twin Exclusive / Twin 6000 Classic</b>		
354947	*	SARGENT Drilled Rim Shell
867429	*	1-1/8" Cylinder Shell
807987	*	Corbin Jumbo 1-1/8" Shell
367019	*†	1-1/8" Cylinder Plug (Profile 51 or 851)
<b>Twin V-10</b>		
354947	*	SARGENT Drilled Rim Shell
867429	*	1-1/8" Cylinder Shell
807987	*	Corbin Jumbo 1-1/8" Shell
353970	*†	1-1/8" Cylinder Plug

\* – Indicates Finished Components.

† – Specify Profile.

Rim Cylinder mounting plates, screws included with cylinder.  
All items available separately below:

Part No.	Description
900210.....	Rim cylinder mounting plate
900211.....	Rim cylinder mounting screws
900209.....	Kit, includes plate and 2 screws
900212.....	Rim cylinder collar rings (Finish 605, 624 & 626 <b>ONLY</b> )
867450.....	Horizontal & Vertical Rim Tailpiece Kit, includes 900209 Kit
867451.....	Lazy Motion Rim Tailpiece Kit, includes 900209 Kit

Aluminum blocking rings, finish 626 or 624 **ONLY**

Part No.	Thickness
900219.....	1/4"
900220.....	3/8"
900221.....	1/2"

Adjustable collar ring, Item No. 900222,  
finish 626,605 or 624 **ONLY**.

Hardened collar ring, Item No. 900223,  
finish 626 or 624 **ONLY**.

Corbin Jumbo Collar, Item No. 900224,  
finish 626, **ONLY**.